



790SE

792SE

794SE

796SE

79c

79ds

79as

79stand

79SE SERIES

mission

IAG House, Sovereign Court, Ermine Business Park, Huntingdon, Cambs, PE29 6XU, UK
Tel: +44(0)1480 447700 Fax: +44(0)1480 431767 <http://www.mission.co.uk>
IAG reserve the right to alter design and specification without notice. All rights reserved © IAG Group Ltd.
Mission is a member of the International Audio Group.

mission



Contents

English	Cautions & Warranty Conditions	2
	User Instructions	3 - 8
	Technical Specifications	9

Cautions

IMPORTANT SAFETY INSTRUCTIONS



This symbol indicates that there are important operating and maintenance instructions in the literature accompanying this unit.



This symbol indicates that dangerous voltage constituting a risk of electric shock is present within this unit.

WARNING: TO REDUCE THE RISK OF FIRE OR ELECTRIC SHOCK, DO NOT EXPOSE THIS APPARATUS TO RAIN OR MOISTURE.

Read these instructions.

Keep these instructions.

Heed all warnings.

Follow all instructions.

DO NOT use this apparatus near water.

Clean only with dry cloth.

DO NOT install near any heat sources such as radiators, heat registers, stoves, or other apparatus (including amplifiers) that produce heat.

Protect the power cord from being walked on or pinched particularly at plugs, convenience receptacles, and the point where they exit from the apparatus.

Unplug this apparatus during lightning storms or when unused for long periods of time.

Refer all servicing to qualified service personnel. Servicing is required when the apparatus has been damaged in any way, such as power-supply cord or plug is damaged, liquid has been spilled or objects have fallen into the apparatus, the apparatus has been exposed to rain or moisture, does not operate normally, or has been dropped.

Install in accordance with the manufacturer's instructions.

WARNING: If using spikes make sure that they do not pierce mains cable etc. under /above the carpet.

When making any connections, switch the amplifier off.

When you switch on your system or change sources, set the volume control at minimum and turn the level up gradually.

DO NOT use your amplifier at full volume.

Avoid extreme settings of tone controls or graphic equalisers. Ideally, they should be set 'flat' or, if possible, bypassed.

DO NOT place heavy objects on top of loudspeaker cabinets.

Ensure that all loudspeakers in the system are correctly wired and are in phase.

DO NOT connect your loudspeakers to the mains supply, except for subwoofers.

DO NOT attempt to dismantle the loudspeaker. There are no user serviceable parts inside and you will render the warranty void.

Site hi-fi electronics away from the loudspeakers on a rigid stand or cabinet.

Loudspeakers should not be placed directly facing other hi-fi units, or share the same shelf or cabinet.

Site unscreened speakers and subwoofers at least 0.5m away from TV sets, computers etc. Some manufacturers forbid the placing of objects on top of their TV sets. Check your TV handbook before installing the centre speaker directly on your TV set. Consult your TV dealer if you are in any doubt.

Use only attachments / accessories specified by the manufacturer.

DO NOT subject loudspeakers to excessive cold, heat, humidity or sunlight.

DO NOT block any ventilation openings.

DO NOT defeat the safety purpose of the polarized or grounding-type plug. A polarized plug has two blades with one wider than the other. A grounding type plug has two blades and a third grounding prong. The wide blade or the third prong are provided for your safety. If the provided plug does not fit into your outlet, consult an electrician for replacement of the obsolete outlet.

The apparatus must not be exposed to dripping or splashing and no objects filled with liquids, such as vases, should be placed on the apparatus.



Use only with a cart, stand, tripod, bracket or table specified by the manufacturer, or sold with the apparatus. When a cart is used, use caution when moving the cart/apparatus combination to avoid injury from tip-over.

CAUTION 79AS SUBWOOFER: The mains power switch for this appliance is located on the rear panel. To permit free access to this switch the apparatus must be located in an open area without any obstructions. The mains power plug must remain freely operable at all times.

CAUTION: Changes or modifications not expressly approved by the manufacturer could void the user's authority to operate this device.

IMPORTANT NOTICE TO UK USERS. The subwoofer is supplied with a plug incorporating a fuse, the value of which is indicated on the pin face of the plug. Should the fuse or plug need to be replaced refer to the instructions on Page 9.

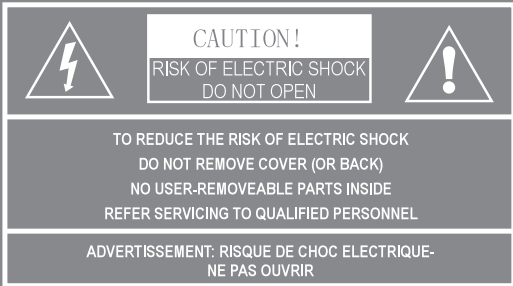

Warranty conditions

The warranty card enclosed should be completed and returned to Mission or its Distributor within 8 days of purchase.

No Dealer or Distributor may vary the terms of this warranty which is personal to the original purchaser and is not transferable.

Please retain the sales receipt as proof of purchase.

Warranty claims must wherever possible be made through the Dealer from whom the equipment was purchased.

This warranty excludes:

Damage caused through neglect, accident, misuse, wear and tear, or through incorrect installation, adjustment or repair by unauthorised personnel.

Any unauthorised servicing will result in loss of warranty.

Liability for damage or loss occurring in transit to or from the purchaser.

Consequent damage, loss or injury, arising from or in conjunction with this equipment.

Equipment for attention under warranty should be considered return carriage paid. If equipment is found to comply with the published specification, Mission reserves the right to raise a charge.

The above conditions do not affect your statutory rights as a consumer.

Welcome to Mission!

The **79SE** series is the latest in a long line of distinguished Mission loudspeakers. These technologically advanced loudspeakers will complement the finest electronics and décor. Bass drivers using Paramid cones with pressure balanced, ventilated spiders and advanced pressure balanced tweeters are used throughout the range. High purity gold-plated binding posts feature on all models. Your Mission **79SE** loudspeakers will bring you great listening pleasure for many years.

General Information

Please read these instructions carefully before installing your loudspeakers. A few minutes studying this manual will ensure superb performance from your loudspeaker for many years.

Please pay attention to all cautions printed on the pages marked with this symbol.



Unpacking Your Loudspeakers

- Carefully unpack each loudspeaker.
- Retain all the packing materials so that your loudspeaker can be repacked and shipped without damage.
- If you dispose of the packing, do so with regard to all recycling provisions in your area.

Fitting Spikes



Warning: Be careful. Loudspeaker spikes are very sharp. When positioning the speakers avoid piercing any electrical cables.

- The **79AS** subwoofer is supplied with the spikes to the unit but you will need to fit the spikes.
- The **794SE** and **796SE** loudspeakers are supplied with the spike retainers fitted to the plinth but you will need to fit the spikes

Fitting the Spikes

- Invert the loudspeaker and place the top on a soft stable surface, or place the loudspeakers on a towel or soft cloth to protect the surface
- Screw a threaded collar on each spike.
- Screw a spike half way into each spike retainer fitted in the base of the cabinet.
- Tighten the collar finger tight onto the spike retainer.
- Carefully return the loudspeaker to its normal position.
- Ensure that spikes do not pierce cables etc. under the carpet.

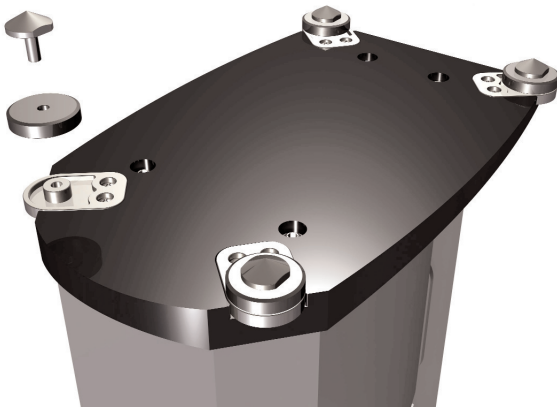

Adjusting the Spikes

- Loosen each collar slightly
- Adjust the height by screwing in or out one or more of the spikes until the loudspeaker is stable and level.
- Tighten the collar fully tight onto the spike retainer.

Connecting your Loudspeakers

Conventional Loudspeaker Connections

Loudspeaker cable is polarity coded along one edge. Split the cable to a depth of about 25mm and strip 8mm of insulation from each wire. If the cable is stranded, twist the strands together.

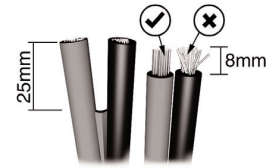

Terminal Panels

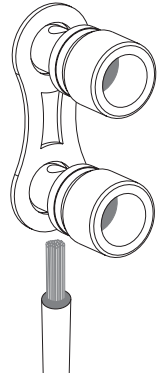

Your loudspeakers use two or four terminals. When single wiring speakers use the connecting links as shown opposite. Unscrew each terminal. Thread the bare end of the cable through the cross-hole ensuring there are no loose strands. Tighten securely.

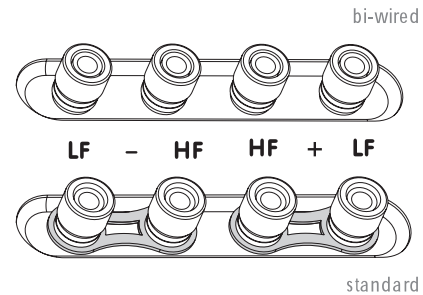

Connect the red, positive (+) terminal of the Left loudspeaker to the corresponding red, positive (+) amplifier terminal. Connect the black, negative (-) terminals similarly. Repeat for the Right Channel.

Bi-Wiring

Most models in the Mission **79SE** Series can be bi-wired for improved performance.

Remove both pairs of shorting links and connect a cable to each pair of terminals, running them to a common connection at the amplifier output terminals.

In the figure to the right, the terminal panel on the left is bi-wired; the panel on the right is conventionally wired. Note the shorting links.

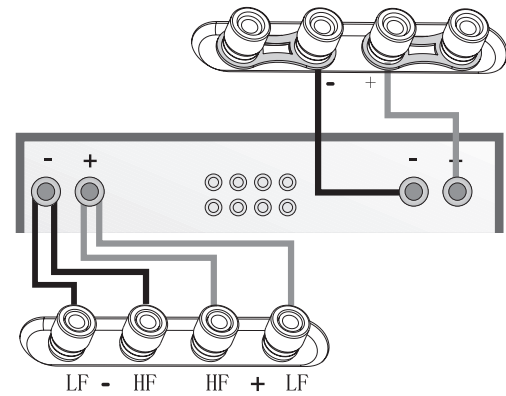

Bi-Amping

By using separate amplifiers for LF and HF drive units you can further improve performance. This is known as bi-amping. Note that the amplifier inputs are linked.

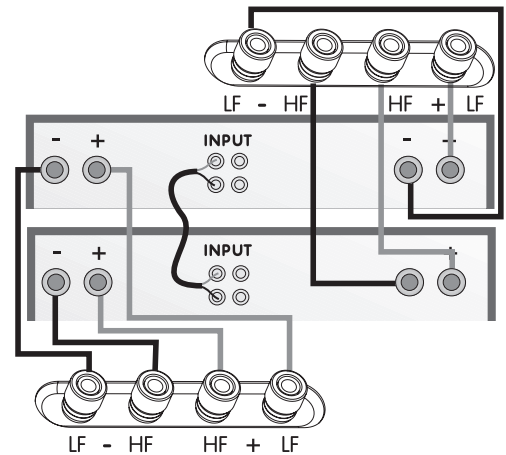

Phase

To check that your loudspeakers are in phase, check the polarity of your speaker wire at the terminal post on the loudspeakers and at the loudspeaker connector on your amplifier. The marked conductor should always be connected to the positive terminals. If your loudspeakers are connected correctly, you hear a full sound with clean midrange and deep and powerful bass.

Positioning your Loudspeakers

Mission **79SE** loudspeakers should be placed on the floor (ideally on spikes). Mission **790SE** and **792SE** should be mounted on rigid stands, ideally spike coupled to the floor.

Height is important: a stand should place the top of a speaker at ear level to a seated listener. Shelf or bracket mounting is second best. The distance from the wall can profoundly affect loudspeakers' sonic performance. If your speakers are too close to the wall the bass will boom and sound coloured. Moving them into the room may increase clarity but tends to reduce bass output. When positioned correctly, the high frequency response is smooth with well-defined, powerful bass.

Start with the speakers about 300mm from the wall and 1.8 metres apart. The distance from each loudspeaker to the side wall should be at least 500mm. Vary the distance between the two loudspeakers and the distance from the wall until you get a perfect stereo stage.

If your loudspeakers are wired correctly, the sound should be full with clean treble and a deep, rich bass.

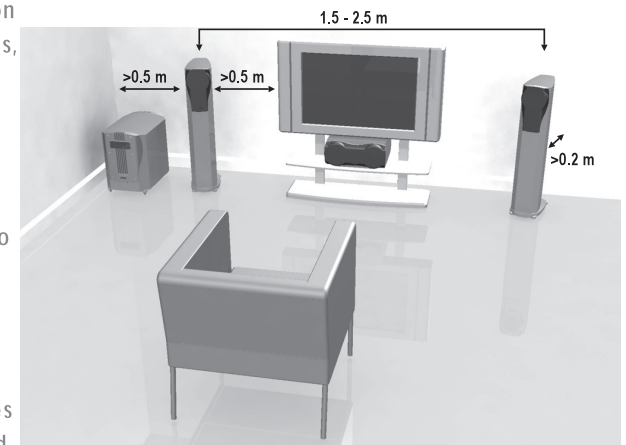

The Mission **79CSE** Centre Channel Speaker

Your **79CSE** centre loudspeaker should be sited on top of the TV monitor, or on a shelf in a console below the TV set. If you place the unit on top of the TV, ensure the cabinet can stand the weight and the assembly is stable. Place the stand on a stable surface and place the **79CSE** on the stand. Ensure the stand is central to the speaker cabinet. Check your TV handbook or consult your TV dealer if you are in any doubt.

Connections: Connect the **79CSE** to the Centre loudspeaker terminals of your AV amplifier. Follow the instructions in the previous sections for connections.

Use: Rotate the speaker on the stand to angle the unit up or down for best results.

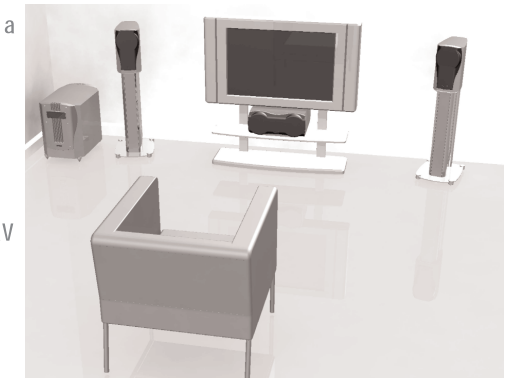

The Mission **79ds** Surround Speaker

The **79ds** is designed for wall mounting. If you are in any doubt about your ability to carry out this procedure, consult a suitably qualified builder or domestic electrician. Ensure the wall is sound, free of obstructions and capable of supporting the loudspeaker plus some pulling force. You will need wall fixings and No 8 Round Head screws to suit your wall. Draw a horizontal line on the wall and mark off two holes at 176mm centres. Drill and plug two holes. Screw 2 No.8 screws into the holes leaving 7mm protruding.

Connect the connecting wire to the loudspeaker but do not connect the cable to the amplifier. Lift the loudspeaker up to the mounting position. Align the keyhole slots over the screw headers and gently pull down until the speaker is securely fastened. You may now connect the the **79ds** to the Rear loudspeaker terminals of your AV amplifier. Follow the instructions in the previous sections for connections.

Place the speakers behind the listening seat above head height 2-4 metres apart as indicated in the diagram.

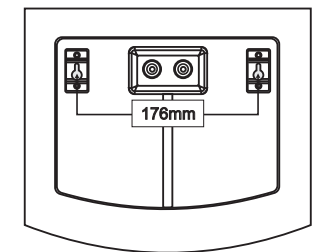

The Mission 79as Powered Subwoofer



Connecting your 79as

Unpack carefully. Retain all packaging materials in case you need to return your subwoofer for servicing.

Fit spikes supplied to the base of the subwoofer, if preferred. Position the subwoofer 300mm or more from room corners. Before connecting check that the mains voltage marked on the amplifier panel is correct for your mains supply.

230 volt products - 220 volts to 240 volts.

115 volt products - 110 volts to 120 volts

Connecting to a Digital AV processor

If your AV processor has a line level or LFE subwoofer output you should use this connection. You will need to purchase a single screened RCA phono lead from your dealer. Connect this lead to the Left line input of the Subwoofer as shown.

Stereo Line Level Connections

Stereo line level connections will be necessary where there is no dedicated single subwoofer output, but where there is a preamp output, or if an integrated amplifier, a pre/main link that can be separated. This output must be controlled by the system volume control.

Speaker Level Connections

To connect a stereo hi-fi amplifier it is recommended that you connect the speaker outputs of your amplifier to the speaker level inputs of the subwoofer in parallel to the connections made to your speakers.

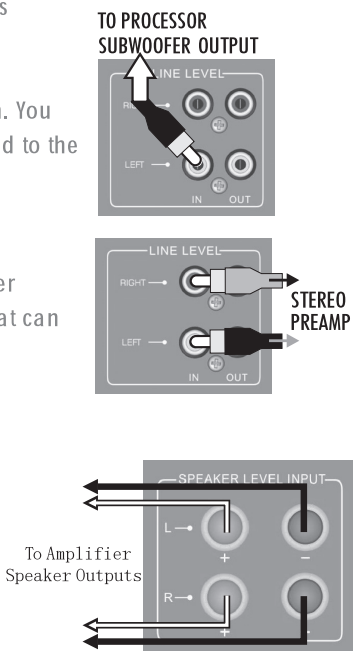

79as Operation

Remote Handset

The handset operates on two LR6 (AA) batteries (supplied). Unwrap the batteries and slide the cover off the battery compartment at the rear of the handset. Place the batteries in the handset following the diagram. Replace the cover.

Switching On

Plug the power cord into the mains socket on the rear panel. Plug the mains plug into the wall socket and switch the power on. Switch on the subwoofer and the rest of your system. The subwoofer ON/OFF switch has a rocker action; press the upper part to switch the equipment on and the lower part to switch it off. When operational the light above the power switch will glow.



Controls and Functions

Control functions are carried out using the remote handset. To operate, the handset must be point at the subwoofer and be in direct line of sight.

Standby: The Standby key brings the subwoofer in and out of Standby. The drawing shows a typical front panel display during operation.

Volume:50_Filter:85
Preset:1 Phase:180

Note: When brought out of standby for the first time, the unit will display the factory presets. Thereafter, bringing the unit out of standby will revert it to the operational state last used. If you switch the power on and off at the rear panel while the unit is in standby, the unit will power up to a normal operating state (i.e. not in standby). To enter standby, again press the Standby key.

Volume: Press the Volume + key to increase the subwoofer volume. Press the Volume - key to decrease the volume .The volume range on the front panel display varies from **00** (minimum) to **99** (maximum).

Low Pass Filters: Pressing the appropriate filter key will select the frequency at which the subwoofer rolls off. The filter has steps at OFF and 35Hz-85Hz in 10 Hz increments. When 'OFF' is selected the subwoofer operates over its full range. Pressing other keys lowers the maximum operating frequency.

Phase: This key toggles the subwoofer between 0° and 180° phase shift.

Presets: Four different settings of level, frequency and phase can be stored. Pressing and holding any preset key on the remote for 3 seconds will cause the current settings to be stored in that preset. The display will show the preset number then flash the preset number once to show it has stored the preset.

To change a different preset, press a preset key on the remote for less than 3 seconds. The preset number will display. If you select a preset and then alter the setup, the preset light will extinguish (as the setup no longer matches the preset).

Setting up the Subwoofer - AV Setup

In a multi-channel system it is recommended that you use the bass management facilities on your AV amplifier. As the subwoofer is best employed to reproduce bass, all low frequency information should be directed to the subwoofer enabling the main speakers to reproduce upper bass, midrange and treble with optimum clarity.

If you are using the bass management of an AV amplifier, set all speakers to SMALL in your amplifier's speaker configuration and set SUBWOOFER to ON. In particular it is essential that the **790SE** is set to SMALL. Set the Low Pass Crossover Frequency control on the subwoofer to 75Hz. Adjust the volume control to its mid position (50)

Use the distance parameters in your AV amplifier speaker setup to set the distance from each set of speakers to your listening position.

Use the channel level adjustment in your AV amplifier speaker setup to set the individual output from each speaker. If you have a sound level meter adjust the individual level of each channel for a reading of 75dB at the listening position. If you do not have access to a sound level meter, set the channel levels so that they sound equally loud at the listening position.

Setting up the Subwoofer - Stereo

In a hi-fi system without bass management you must adjust the FILTERS on the subwoofer in conjunction with the VOLUME level to achieve a blend to your main speakers. Start by setting the filter to 55Hz and adjust the SUBWOOFER volume level to provide a natural level of bass support when playing music discs. For the **796SE** speakers, start by setting the filter to 45Hz.

Adjusting the controls

Once you have completed the settings you should fine-tune the subwoofer controls. Choose a disc with natural bass qualities - a music disc is best.

Adjust the PHASE control to tune the blend between the subwoofer and speakers. Depending on your room acoustics the sound will be fuller and more coherent in either the 0° or 180° position. Use your judgement to set this control to the best sounding position.

Loudspeaker Maintenance

Use a slightly dampened cloth to clean your cabinets and occasionally, a light spray polish to protect their sheen. If necessary clean grilles carefully with a soft brush. Subwoofers should only ever be cleaned with a soft dry cloth.

Product Service

Should a fault occur with your loudspeakers please return them as a pair, even if only one unit appears to be faulty. Please pack them correctly, using the original packing.

Product for service should be returned to the appointed dealer from whom you purchased the product. If you experience difficulties or there is no Mission dealer in your area, contact the Mission distributor for your country or the Main Service Centre for your region.



Specifications

	790SE	792SE	794SE	796SE	79CSE	79ds
Recommended Amplifier:	50 - 150W	50 - 175W	50 - 200W	50 - 200W	50 - 200W	25 - 100W
Enclosure:	2-way reflex	2-way reflex	3-way reflex	3-way reflex	2-way reflex	2-way sealed
Effective Volume:	7 litres	11 litres	19 litres	32 litres	7,2 litres	4,5 litres
Frequency Response \pm 3dB:	65 Hz - 20 kHz	58 Hz - 20 kHz	48 Hz - 20 kHz	38 Hz - 20 kHz	70 Hz - 20 kHz	70 Hz - 20 kHz
Sensitivity SPL/M @ 2.83V:	87 dB	88 dB	89 dB	90 dB	87 dB	87dB
Impedance:	8 Ohms compatible	8 Ohms compatible	8 Ohms compatible	8 Ohms compatible	8 Ohms compatible	8 Ohms compatible
Minimum Impedance	5,6 Ohms	5,6 Ohms	5 Ohms	4 Ohms	5,6 Ohms	6,8 Ohms
Dimensions (H x W x D): mm	330 x 170 x 270	360 x 206 x 340	795 x 165 x 295	998 x 206 x 318	172 x 395 x 290	220 x 260 x 125

Warning: When an amplifier is driven beyond its power output capabilities it will produce distorted results which will quickly damage your speakers by overheating. Make sure that your amplifier is not left unattended when playing, for example at parties, and turn the volume control down at the first sign of audible distortion. Playing music at extremely high volumes for extended periods can permanently damage your hearing.

Specifications

	79as
Recommended Amplifier:	Integrated 300W amplifier
Enclosure:	sealed box
Effective Volume:	42 litres
Frequency Response \pm 3dB:	25Hz - 110Hz
Sensitivity:	250mv for 100W
Bass:	1 x Long-throw Tri-Lam 250mm driver
Dimensions (H x W x D): mm	460 x 310 x 500

Mission reserves the right to change all specifications without notice. E & OE

HANDSET BATTERIES: Use AA batteries and replace them in pairs. Do not mix old and new batteries. Never short circuit batteries or leave them lying around. Do NOT dispose of used batteries in a fire, the general rubbish or water. Dispose of batteries having regard to the recycling regulations in force in your area.

Note to UK Customers

The power cord on your Mission powered subwoofer is supplied with a plug incorporating a fuse, the value of which is indicated on the pin face of the plug. Should the fuse need to be replaced, an ASTA or BSI approved BS1362 fuse must be used of the same rating. If the plug is cut off it must NOT be re-used. Dispose of any such plug safely. There is a danger of electric shock if a cut-off plug is inserted into a mains socket.

The wires in the mains lead are coloured in accordance with the following code:
Blue - Neutral: Brown - Live.
As the colours of the wires in the mains lead may not correspond with the markings identifying the terminals in the replacement mains plug, proceed as follows:
The wire coloured Blue must be connected to the terminal marked with the letter "N" or coloured Black. The wire coloured Brown must be connected to the terminal marked with the letter "L" or coloured Red.

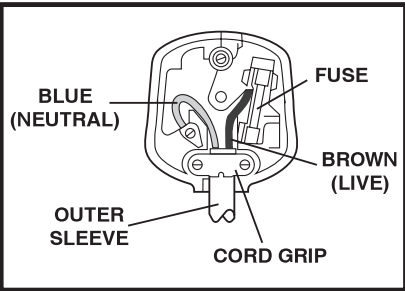

MAIN SERVICE AGENTS

UNITED KINGDOM:

IAG Service Centre, Unit 4, St Margaret's Way, Stukeley Meadows Industrial Estate Huntingdon, Cambs, PE29 6EB
Tel: +44 (0)1480 447700 Fax: +44 (0)1480 431767

ASIA:

IAG Sales and Service Centre, Jiuwei Village, Xixiang Town, Shenzhen, China 518102
Tel: +86-755-27484491 Fax: +86-755-29651484